



FAQ

EN : To learn more about Powerline Network security, please visit the FAQ section for Powerline products at www.strong-eu.com

FR : Pour en savoir plus sur la sécurité des réseaux CPL, veuillez consulter la section FAQ relative aux produits CPL sur www.strong-eu.com

NL : Voor meer informatie over de beveiliging van Powerline-netwerken, kunt u de FAQ-rubriek voor Powerline-producten bezoeken op www.strong-eu.com

CZ : Další informace o zabezpečení sítě Powerline najdete v sekci Často kladené dotazy (FAQ) pro produkty Powerline na www.strong-eu.com

SK : Ďalšie informácie o sieťovom zabezpečení produktov Powerline nájdete v časti s najčastejšie kladenými otázkami pri produktoch Powerline na lokalite www.strong-eu.com

PL : Aby dowiedzieć się więcej o zabezpieczeniach sieci powerline, odwiedź sekcję FAQ na stronie www.strong-eu.com

STRONG

CPL 600S DUO

POWERLINE 600S DUO

Mbps
600
Mbit/s



4 Years warranty
ans de garantie

Instructions d'installation
Installation instructions
Instalatie instructie
Instrukce k instalaci
Návod na inštaláciu

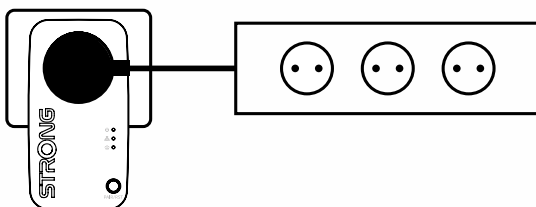
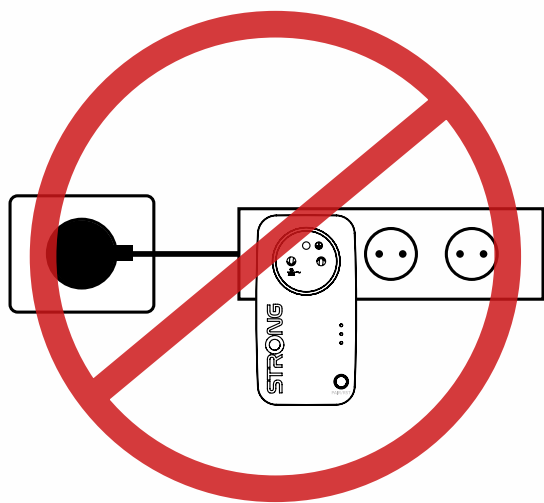

***EN**: Status of the Powerline lights:
Green: Normal operation

***NL**: Status van de Powerline-lampjes:
Groen: Normale werking

***CZ**: Stav kontroliek Powerline:
Zelená: Normální provoz

***SK**: Stav kontroliek Powerline:
Zelená: Normálna prevádzka

***PL**: Status diod Powerline:
Zielony: Prawidłowe działanie

SERVICE CENTER

AT	✉ support_at@strong-eu.com ☎ 0820 400 150 (€ 0,12/Min. österr. Festnetz)	FR	✉ support_fr@strong-eu.com
BG	✉ support_bg@strong-eu.com ☎ +359 32 634451	IT	✉ support_it@strong-eu.com
CEE	✉ support_hu@strong-eu.com ☎ +36 1 445 26 10	NL	✉ support_nl@strong-eu.com
DE	✉ support_de@strong-eu.com ☎ 0800 7788 787 (Gebührenfrei)	PL	✉ support_pl@strong-eu.com ☎ 801 702 017
DK	✉ support_dk@strong-eu.com	UA	✉ support_ua@strong-eu.com ☎ +380 (44) 238 61 50

www.strong-eu.com

Supplied by STRONG AUSTRIA
Represented by STRONG Ges.m.b.H.
Teinfaltstraße 8/4, Stock
A-1010 Vienna, Austria
Email : support_fr@strong-eu.com

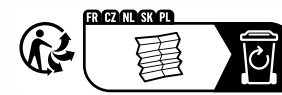

1

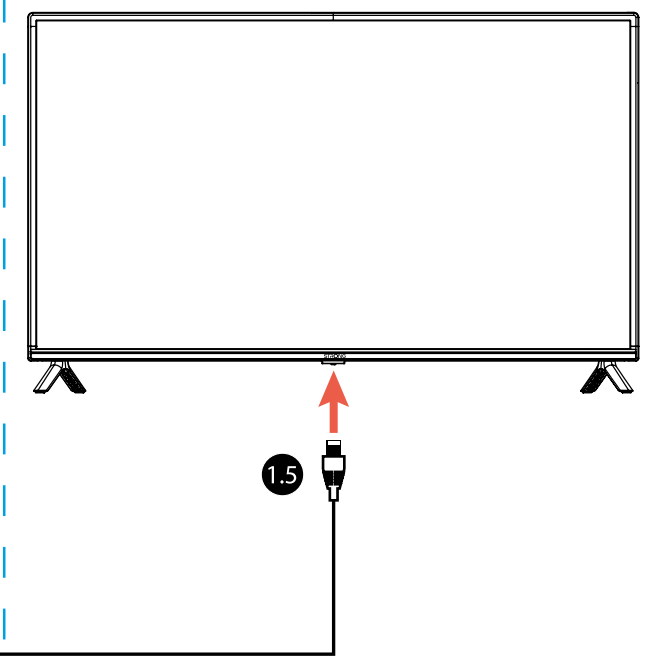
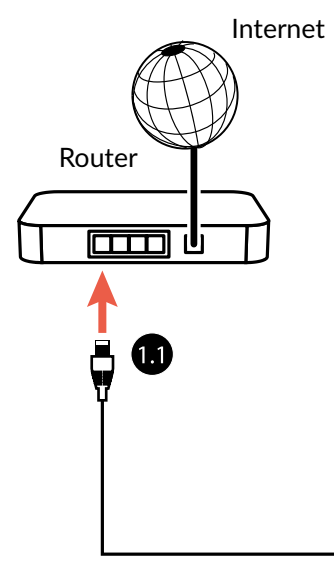

État des voyants du CPL :
Vert : Fonctionnement normal*

2

