



We. SEE

We. SEE 55 | We. SEE 50 | We. SEE 43 | We. SEE 32

User Manual (part 2 of 2)



73496000



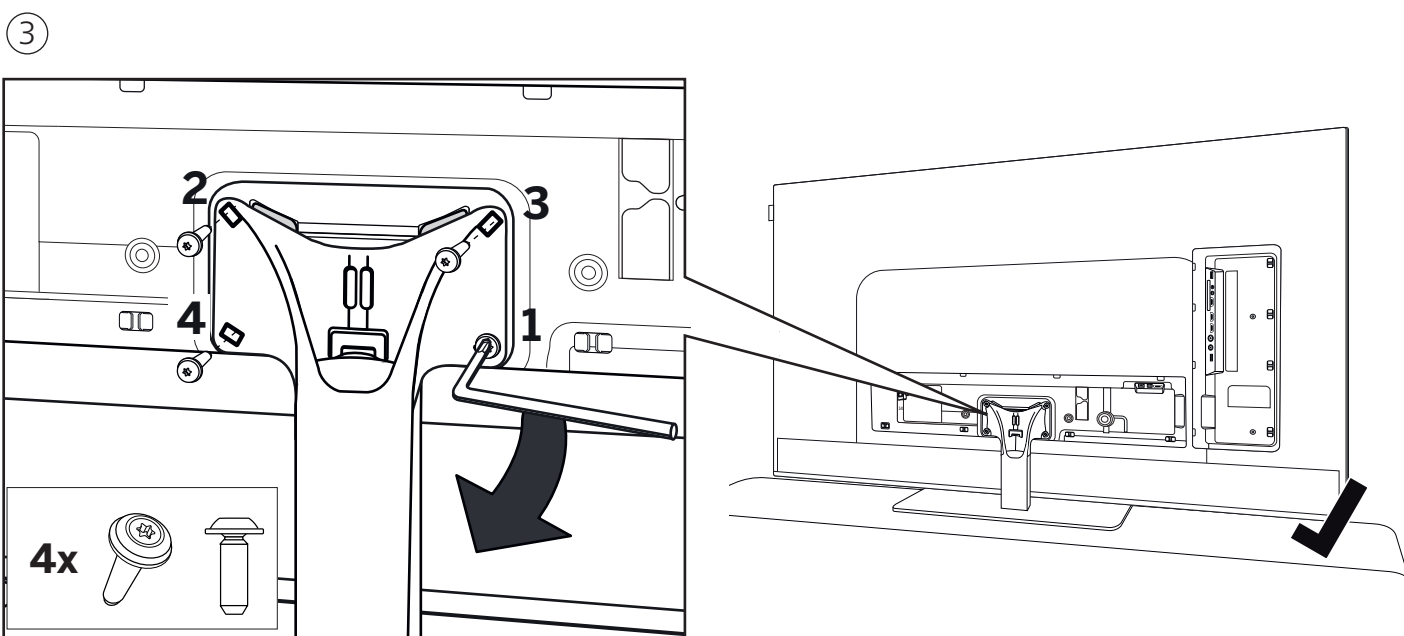
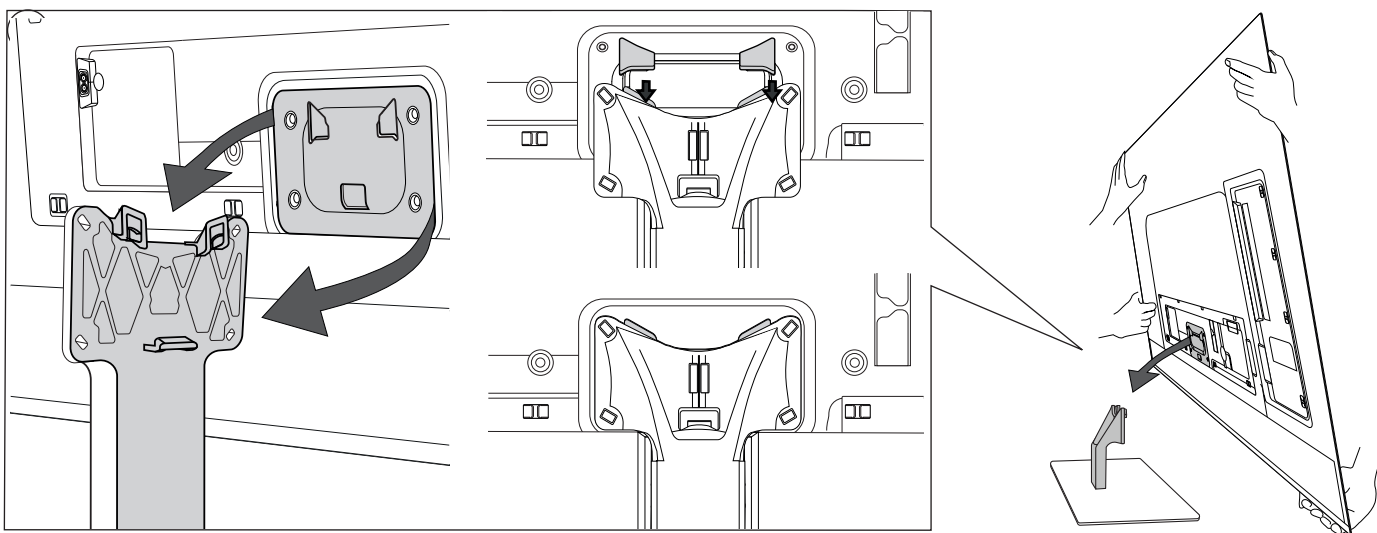
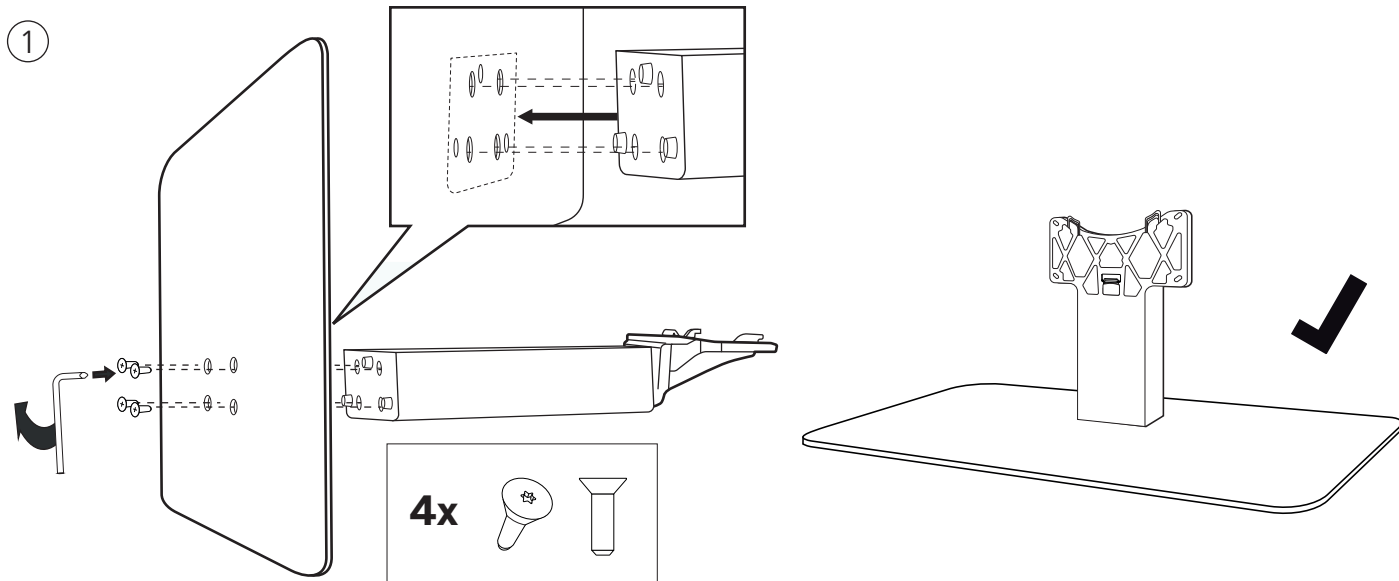

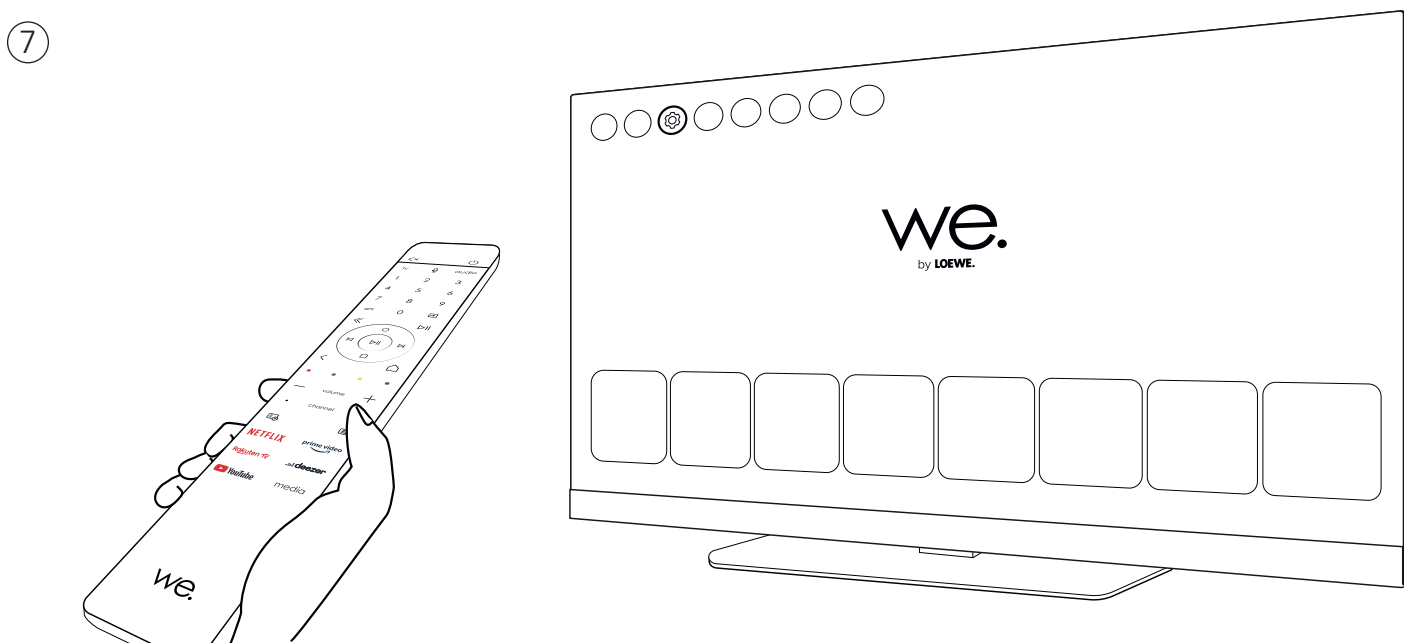
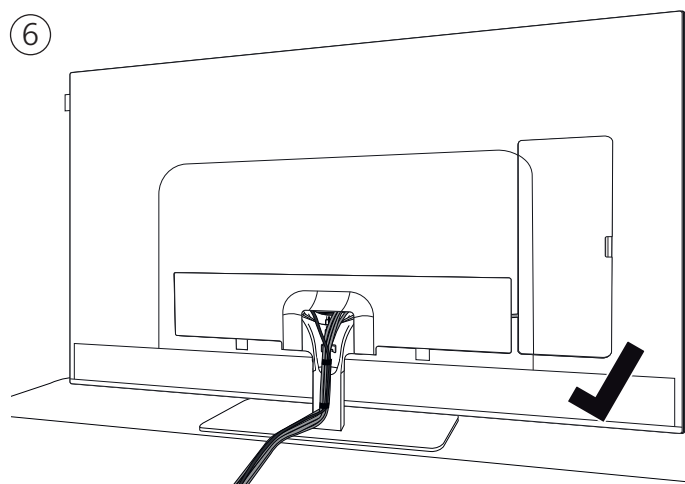
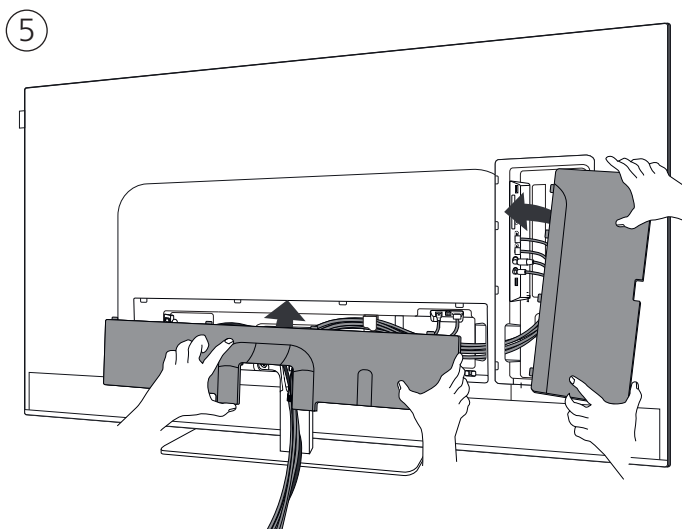
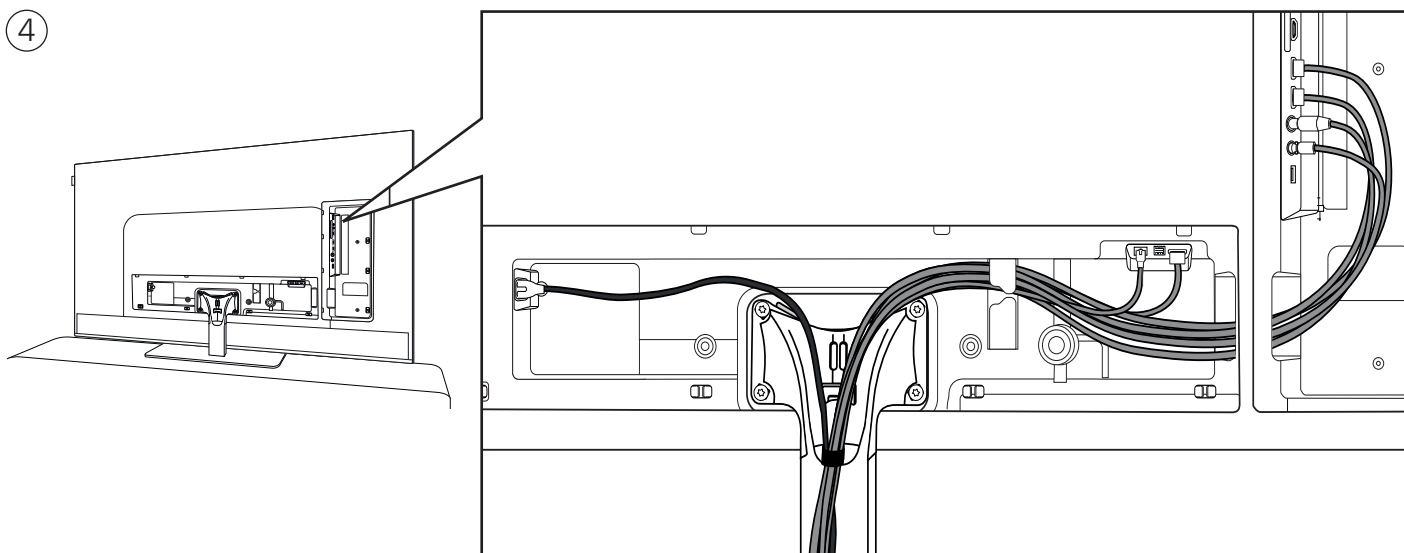

Thank you

for choosing a We. by Loewe product.

We are happy to have you as a customer. At Loewe, we combine the highest standards of technology, design and user friendliness. We. by Loewe stands for innovative, functional and intuitive product design. The young brand is closely linked to Loewe's nearly hundred-year-old design tradition and translates its core elements into the future.

With the aim of a safe and long-term fault-free use of the set, before putting the TV set into operation, please read the chapter **Safety/Warning** on the next page.

Table of contents

| | |
|---|----|
| Introduction | 14 |
| Delivery specification..... | 14 |
| Documentation | 14 |
| Position of the rating plate | 14 |
| Safety/Warning | 15 |
| Remote control button mapping..... | 17 |
| Position and function of the connections | 18 |
| Preparing the remote control..... | 19 |
| Inserting or replacing batteries | 19 |
| Connecting the TV set..... | 19 |
| Connecting antennas | 19 |
| Connecting an external device via HDMI cable..... | 19 |
| Connecting to an audio system via HDMI eARC | 20 |
| Connecting to an audio system via optical audio cable | 20 |
| Connecting to an audio system via analogue audio cable | 20 |
| Connecting to the mains supply..... | 20 |
| Getting started- first steps..... | 20 |
| Home menu | 21 |
| Electronic Programme Guide – EPG | 22 |
| Technical data | 23 |
| Environment..... | 24 |
| Disposal..... | 24 |
| Licenses..... | 24 |
| Technical information | 25 |
| Conformity/Manufacturer's declaration | 25 |
| Imprint | 25 |

Delivery specification

- TV
- User Manual (part 1 of 2)
- Rotation unit
- Table stand base plate
- Welcome Box:
 - Remote control with two alkaline batteries type AAA
 - Mains cable
 - User Manual (part 2 of 2)(this document)
 - Installation instructions for table stand
 - Screws for installation of setup solution
 - Tool set for installation of setup solution

Documentation

This part of the operating manual contains essential basic information. The device is commissioned and set up by means of the intuitive operation guide after the device has been switched on for the first time.

A detailed user handbook describing the functions and features of your new We. by Loewe set can be downloaded in electronic form from the We. by Loewe website.

Please note that detailed user handbook may not be available immediately after the product is placed on the market.



The user handbook is updated regularly.

Please find a detailed user handbook here:

<https://my.loewe.tv/manuals/bild>

Simply scan the QR code.

Visit our service homepage under:

www.loewe.tv/int/support

In this section, you will also find the FAQ - frequently asked questions.

Position of the rating plate

Label with model number and operating voltage can be found on the back of the TV set.

Safety/Warning

For your safety, and to avoid unnecessary damage to your unit, please read and follow the safety instructions below.

Key



This symbol indicates risks caused by high voltages.



This symbol is to alert the user to other, more specific risks.



This symbol indicates dangers caused by the development of fire.



This symbol indicates dangers caused by sharp edges.

Do not remove set rear panel

Warning: When opening or removing the rear panel, there is the danger of electric shock and the risk of serious injury from high voltages.

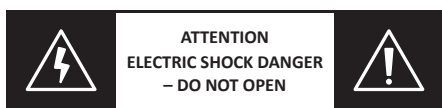

Never open the rear panel yourself. Leave repairs and servicing work on your TV set to qualified, authorised television technicians.

Please contact your dealer or our customer service.

Intended use and environmental conditions

This TV set is intended exclusively for the reception and playback of picture and sound signals.

The TV set is designed for dry rooms (living rooms and office spaces). It must not be used in rooms with a high level of humidity (e.g. bathroom, sauna) or outdoors.

When using the set, make sure that it is protected from moisture (dripping and splashing water or condensation).

High humidity and dust concentrations lead to power leaks in the set. This can lead to danger of injury and damage to the set by electric tensions or a fire.

If you've brought the set from the cold into a warm environment, leave it off for around an hour due to the formation of condensation.

Do not place objects filled with liquid over the set. Protect the set from dripping and splashing water.



Candles and other open flames must be kept away from the set at all times to prevent the fire from spreading.



The materials we used in this device comply with all regulatory requirements. However, the migration of substances cannot be ruled out. We therefore suggest you avoid permanent contact between food and the TV set.

Transport



Improper handling during transportation can lead to damage to the display and risks of injury.



The screen consists of glass or plastic and can break if handled improperly.

At least two people are required to transport the set. Only transport the set in a vertical position.

No pressure should be applied to the glass or the plastic during transport.

The correct unpacking of the set is shown in the operating manual 1.

To avoid damaging the mechanical structure of the TV set and the floor stand, remove the TV set from its base and move the two parts separately. When the TV set is set up in its new location, at least 2 people are required to reassemble it.

Mains cable/power supply



Unplug the power cord immediately from the mains socket if you notice something unusual, or the unit shows recurring malfunctions.



Incorrect voltages can damage the set.

This set may only be connected to a mains power supply with the voltage and frequency indicated on the rating plate using the enclosed mains cable.

The mains power plug of the TV set must be easily accessible so that the set can be disconnected from the mains at any time.

When pulling the mains power plug out, do not pull the cable but the plug housing. The cables in the mains power plug could be damaged and cause a short circuit when plugged in again.

A mains power cable with a damaged insulation can lead to electric shock and presents a fire hazard. Never use a damaged mains cable.

Lay the mains cables so that they cannot be damaged. Do not tread on the mains cable.

If you use a portable multiple socket to connect the TV set, do not cascade several multiple sockets consecutively.

Air circulation and high temperatures



Like any electronic device, your TV set requires air for cooling. If air circulation is impeded, it may result in a fire.

The ventilation slots on the rear panel of the set must therefore remain free. Please do not cover the set.

Wall mounting: Leave at least 10 cm of space all around the set at the side, above and below.

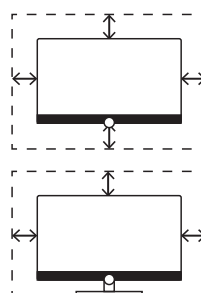

Table / stand foot: Leave at least 10 cm clear space around the set at the side and at the top.

Foreign bodies



Foreign bodies inside of the set can lead to short circuits and fires.

Danger of injury and damage exists.

Therefore avoid metal parts, needles, paper clips, liquids, wax or similar passing through the ventilation slits of the rear panel into the interior of the set.

Should something get into the interior of the appliance, immediately pull out the mains power plug of the set and inform the customer service department for checking.

Installation



Never place a television set in an unstable location. A television set may fall, causing serious personal injury or death. Many injuries, particularly to children, can be avoided by taking simple precautions such as:

- Using cabinets or stands recommended by the manufacturer of the television set.

- Only using furniture that can safely support the television set.

- Ensuring the television set is not overhanging the edge of the supporting furniture.

- Not placing the television set on tall furniture (for example, cupboards or bookcases) without anchoring both the furniture and the television set to a suitable support.

- Not placing the television set on cloth or other materials that may be located between the television set and supporting furniture.

- Educating children about the dangers of climbing on furniture to reach the television set or its controls.

If the existing television set is going to be retained and relocated, the same considerations as above should be applied.

We. by Loewe TV sets are specified for Loewe accessories. We strongly recommend the use of original Loewe setup solutions.

Note the instructions regarding the mounting for the different possible setup solutions! A corresponding documentation is included with every Loewe product.

Check before the installation of the set, whether the final location with regard to the surface (pressure sensitivity) and stability (static) is designed for the load from the set! This applies in particular to high-gloss lacquered surfaces and surfaces made of real wood, real wood veneer and plastic surfaces.

The usual usage position of the TV set should be followed. The TV set can only be operated horizontally upright (A). The inclination can amount to a maximum of 10 degrees for wall mounting (B). The TV set must never

be operated in portrait orientation, (C), horizontal (D) or overhead on the ceiling (E). Position the set so that it is not exposed to direct sunlight and additional heating from radiators!

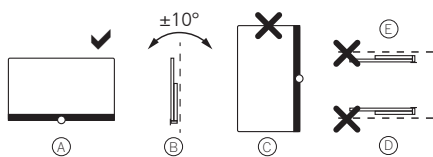

Do not place the TV in a location where vibrations can arise! This can lead to damage.

In the case of setup solutions for third-party manufacturers with a motor drive, it is to be ensured that the adjustment of the TV set does not occur manually. It is generally not advisable to use the installation options of other manufacturers with locking devices in certain positions.

When using accessories from third-party manufacturers, please ensure that you can adjust the TV set easily to the respective setup solution.

When adjusting the TV set, ensure that the pressure applied to the set frame is not too great. Especially in large format displays, there is the danger of damaging the display.

The mounting of a TV set on a holder according to the VESA standard requires **mandatory** use of the Loewe VESA adapter bolts. Otherwise, damage to the TV may result.

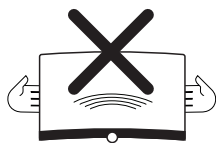

The Loewe VESA adapter bolts must be attached to the TV set with a torque of approx 4 Nm. You can obtain these from your Loewe dealer (you can find further information found in the online user handbook).

Make sure that after unpacking and setting up the TV set the packaging material does not fall carelessly into the hands of children.

Please also note the disposal instructions for packaging and carton (see chapter **Environment/Disposal/Licences**).

Supervision



Do not let unsupervised children handle the TV set nor let them play in the immediate vicinity of the TV set!

The set could be knocked over, moved or pulled down from the stand surface and injure people.

Do not leave the TV set unattended when switched on!

Volume



Loud music can lead to hearing damage. Avoid extreme sound volume, especially over extended periods of time and when using headphones!

Thunderstorms



Electrical surges due to lightning strike can damage the set both via the antenna system and via the mains power supply.

During thunderstorms, pull out the mains power plug and all connected antenna cables from the TV set!

If you have connected a network cable to the LAN port, remove this as well!

Even in the case of prolonged absence, the mains power plug and all connected antenna cables should be disconnected from the TV set.

Cleaning and care/chemicals



Before cleaning, switch the TV set off using the mains power switch!



Damages caused by chemicals can lead to adverse effects and development of fire.

Never expose the set or accessories to aggressive (e.g. corrosive) chemicals such as alkalis or acids!

Only clean the TV set, the front screen and the remote control with a damp, soft, clean and colour neutral cloth, without any aggressive or scouring cleaning agents!

The loudspeaker panel of your TV set is textile-covered. Hoover the surface regularly with a soft brush attachment!

For contaminations or stains:

Moisten a soft, colour neutral cloth with detergent solution or commercially available stain remove and rub the stain gently away! You can also treat the stain directly with a commercial dry stain remover spray (hoover up the dust).

Do not moisten the covering fabric directly with detergent solution or stain remover (risk of stain circle formation)! Do not use solvents to clean the fabric!

Note the usage instructions of the manufacturer when using stain remover!

When cleaning loudspeaker panels which have been exposed to nicotine, there is an increased risk of stain circle formation.

Remote control button mapping

Depending on the application (TV / video / audio / photo / apps) and function (for example, EPG, Teletext, HbbTV etc.), the key assignment can deviate from the assignment described here.



Note: The key assignment may differ depending on the software or device version.

Position and function of the connections

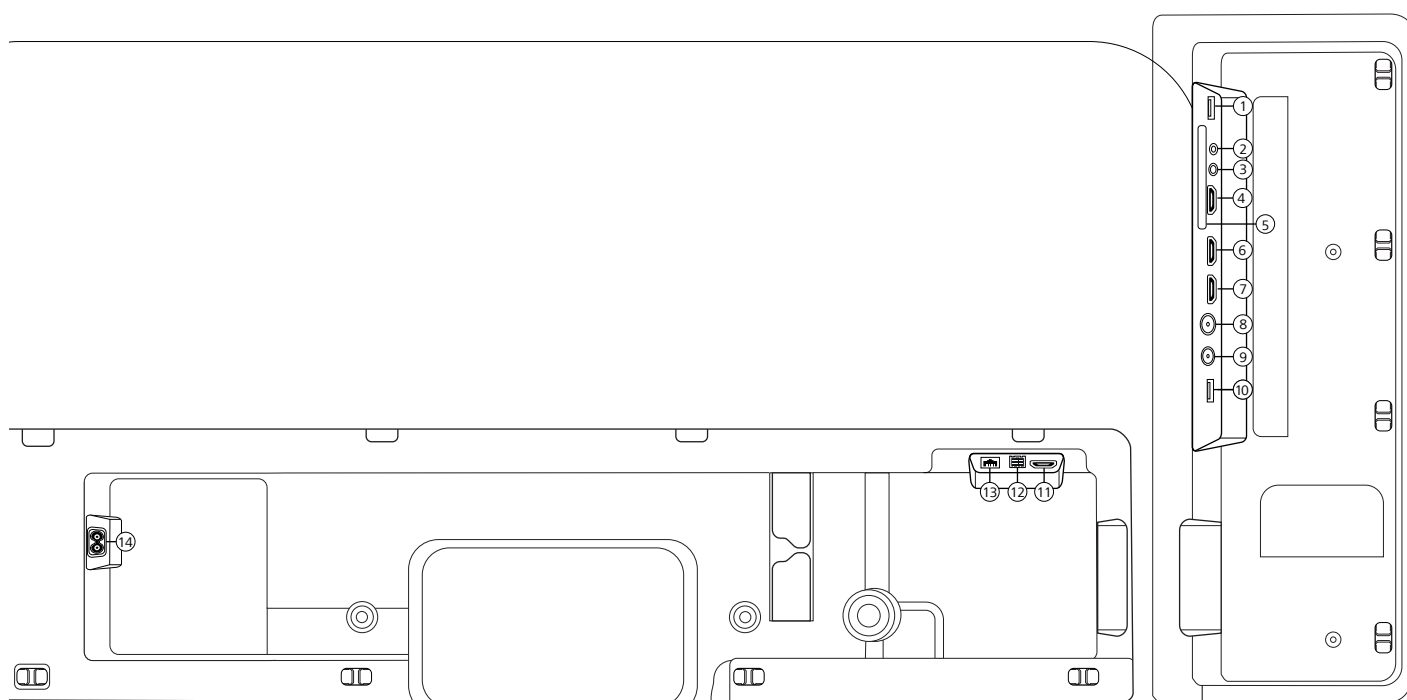

- | | |
|---|---|
| <p>① USB 3.0 - USB connection USB type A – USB 3.0 (max. 1000mA)</p> <p>② AUDIO OUT- Audio output Jack 3,5 mm (analogue) L/R</p> <p>③ SERVICE</p> <p>④ HDMI 1 - HDMI input 1 HDMI – Digital Video IN/Audio IN/OUT</p> <p>⑤ COMMON INTERFACE -CI slot 1 (standard V1.4)</p> <p>⑥ HDMI 2- HDMI input 2 (with enhanced Audio Return Channel) HDMI – Digital Video IN/Audio IN/OUT</p> <p>⑦ HDMI 3- HDMI input 3 HDMI – Digital Video IN/Audio IN</p> | <p>⑧ ANT TV- Terrestrial/cable analogue / DVB-T/T2/C HD IEC socket – 75 Ohm / 5 V / 80mA</p> <p>⑨ ANT SAT - Satellite antenna DVB-S/S2 HD F socket – 75 Ohm / 13/18 V / 500mA</p> <p>⑩ USB 2.0 - USB connection USB type A – USB 2.0 (max. 500mA)</p> <p>⑪ HDMI 4¹⁾- HDMI input 4 HDMI – Digital Video IN/Audio IN</p> <p>⑫ TOSLINK- Audio output TOSLINK (digital)</p> <p>⑬ LAN- Network connection RJ-45 – Ethernet / Fast Ethernet</p> <p>⑭ AC IN - Mains connection Mains socket- 220-240 V- 50 / 60 Hz</p> |
|---|---|

¹⁾ HDMI 4 input is not available on the We. SEE 32.

Preparing the remote control

Removing the battery protection

The remote control is supplied with batteries. To make them ready for use, remove the plastic flag as shown below.



Inserting or replacing batteries

Press and slide open the battery compartment cover on the top of the remote control.

Only use leak-proof micro-cells of the LR 03 (AAA) Alkali-Manganese type. Do not use different types of batteries and do not mix old and new batteries together.

Make sure that the batteries do not get into the hands of children. The batteries used must not be exposed to excessive heat such as sunlight, fire or similar!

Note: The position of the batteries is indicated in the battery compartment (in opposite directions). Pay attention to the correct polarity of + and – when inserting the batteries. Do not be guided by the battery contacts (springs), but by the illustration at the bottom of the battery compartment.

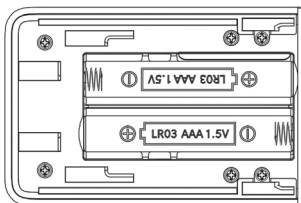

Dispose of used batteries in an environmentally friendly way (see chapter Environment/Legal information).

Push the cover back on after having inserted the batteries.

Connecting the TV set

Before making any connections to an external device, make sure both TV set and device are disconnected from power.

The TV connectors are hidden under the back cover. Remove the back cover and connect the cables as shown in the illustrations below.

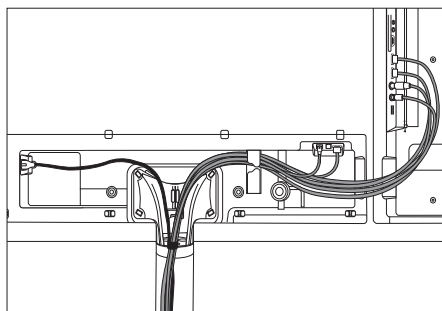
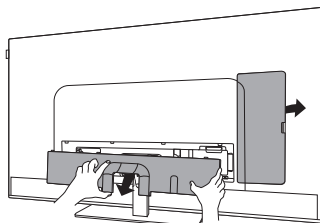

When you have finished connecting external devices to the TV, replace the back cover.

Connecting antennas

Terrestrial / cable analogue / DVB-T/T2/C HD antenna:

Plug the cable of antenna, cable TV system or room antenna into the ANT TV socket.

If you want to use analogue cables/DVB-C connection and a DVB-T antenna together, use an external antenna switch (available from your dealer).

Satellite antenna DVB-S/S2 HD:

Connect a connecting cable from the from the LNB to the ANT SAT socket of the TV set.

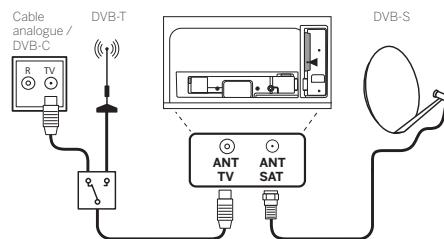

Connecting an external device via HDMI cable

The HDMI connections (High Definition Multimedia Interface) allow the transmission of digital video and audio signals from a player (e.g. DVD player, Blu-ray player, camcorder, set-top box) via a single cable.

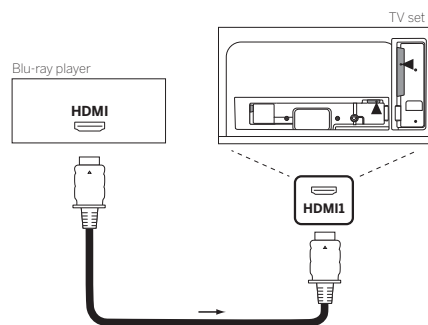

Connect the device by an HDMI cable with a Type A connector (not supplied) to one of the HDMI sockets of the TV set. To fully enjoy the capabilities of your TV, use a cable labelled „Premium High-Speed HDMI Cable“ or better.

Connecting to an audio system via HDMI eARC

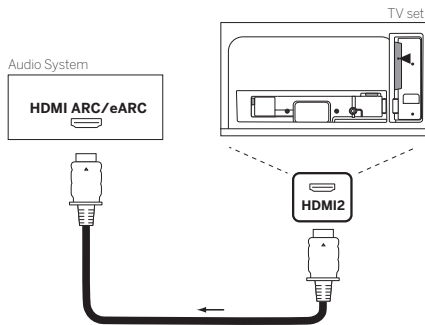

Use an HDMI cable (not supplied) to connect HDMI eARC socket of the TV set to the HDMI ARC/eARC socket of an audio system or soundbar. It is recommended to use a cable marked as „Ultra High-Speed HDMI Cable“ with a Type A connector.

Ultra High Speed HDMI Cables are designed to support the new eARC feature in addition to the highest resolution video modes. The Standard HDMI Cable with Ethernet and the High Speed HDMI Cable with Ethernet will also support eARC.

Connecting to an audio system via optical audio cable

Before making this connection, ensure you removed plastic protection caps from the cable connectors.

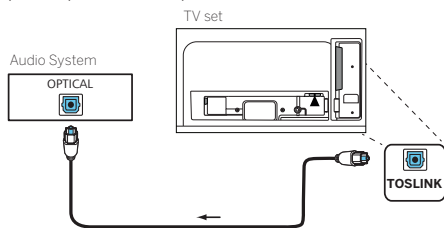

Connect the audio output of the TV labelled TOSLINK to the digital audio input of an audio system.

Connecting to an audio system via analogue audio cable

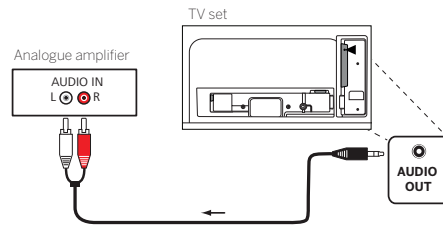

Use a stereo cinch/jack adaptor cable to connect the audio output AUDIO OUT to the analogue audio input of the audio system.

Connecting to the mains supply

Connect the TV set to a 220-240V mains socket.

Plug the mains supply cable into the mains supply connector (AC IN) of the TV and guide the cable out of the TV as shown on the picture below.

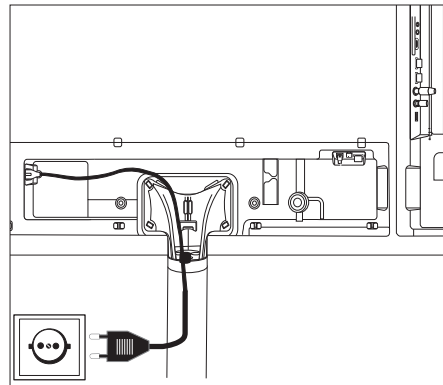

Connect the mains supply plug of the mains supply cable to a power outlet.

Getting started- first steps

Before starting the TV for the first time, make sure that you have completed the connection of your external devices and that the TV is connected to the power supply.

1. Press the  (Standby) button on the remote control to turn on the TV.
2. You will be welcomed by the Installation wizard which will help you to set up the TV set in a few simple steps.

To navigate in the Installation wizard:

- Use the arrow buttons to select the desired item.
- Press the OK button to confirm the selected item.
- Press the  button to go back one step.

STEP 1 – Select the language

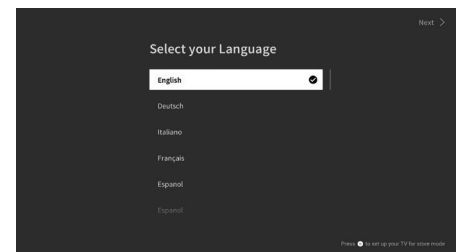

STEP 2 – Connecting to the internet

Optional step. If you wish to skip this step, press the right arrow button.

If you have connected the TV to your home network with an Ethernet cable and your network configuration allows DHCP, you will be automatically connected to the Internet.

Alternatively, you can use Wi-Fi connection. You must first select your network from a list of available networks. You will then be prompted to enter your Wi-Fi password. You can do this by typing on the on-screen keyboard.

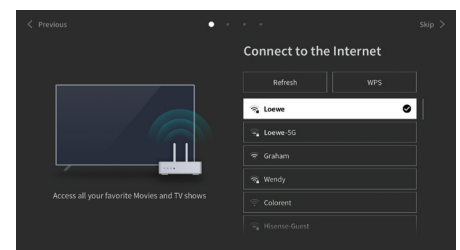

STEP 3 – Select the country

Select the country in which TV set will be used. This will enable the TV to install optimal functions for the country selected.

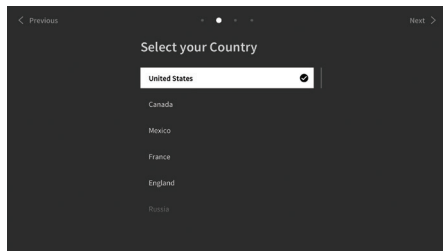

STEP 4 – Terms & Conditions

Carefully read all the information provided about the terms and conditions! If you choose to clear some or all of the check boxes, some or all of the smart features will be turned off. You can change these settings later in the [Support] menu.

Continue to the next step by selecting [OK].

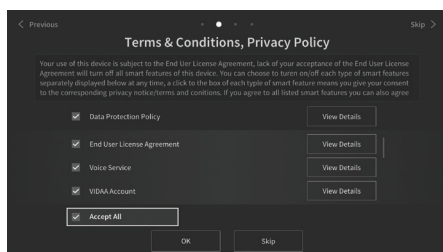

STEP 5 – Sign in to VIDAA account

Optional step. If you wish to skip this step, press the right arrow button.

Sign in to your existing VIDAA account or create a new one.

A VIDAA account gives you all the best features of your smart TV and always keeps it up to date.

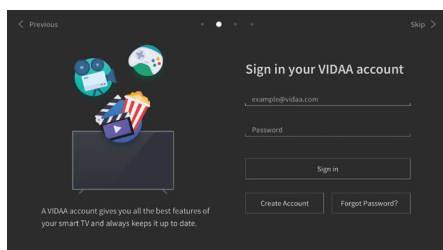

STEP 6 – Input source selection

Select one of possible inputs as default source.

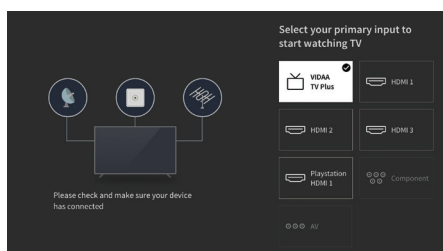

If you selected TV as your default source, you will have option to tune in channels.

Select one of the options from which you wish to tune channels: [Satellite], [Antenna], [Cable]

Set the desired tuning options and start tuning.

Home menu

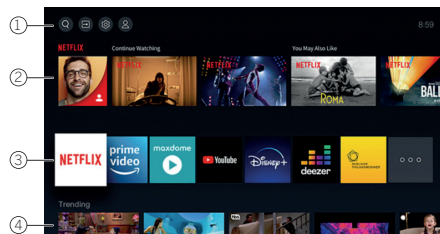

The Home menu is the central overview page of your TV set. From this menu, you can search for content, manage input sources, or enter system settings.

You can enter home menu by pressing (Home) button.

1. Top menu (Search, Inputs, System Settings, Profile)

- Search – allows you to search for applications by keywords.
 - Sources – Select or rename the input source. You can access locally connected devices (such as AV, HDMI, USB).
 - System settings – opens the TV configuration menu e.g., with settings for picture, sound, Network.
 - Profile information – allows you to log in to your VIDAA account.
- The time is displayed at the top right of the screen.

2. List of recommendations

This row contains a list of recommendations for the application that is currently selected. This list of recommendations only appears for some applications.

3. List of apps

This row contains a list of favourite apps. The library of all installed apps is available by accessing 'My Apps' tile in same row.

Add applications to the Home menu:

- Enter apps library by accessing 'My Apps' tile.
- In the library, select the app you want to add to home menu.
- Press (Settings) button, select option [Sort] and confirm with OK.
- You can now move the app tile in the list by using the arrows on the remote control.
- Move the app tile to a new position in the top row of apps and confirm the new position by pressing OK.

4. Additional rows

Additional rows are dedicated to recommendations from your installed apps.

Electronic Programme Guide – EPG

EPG stands for Electronic Programme Guide and provides you with on-screen programme details. With the system, as with a printed programme guide, you can learn about the current programme. In addition programmes can be memorised and also recordings can be programmed.

To open/close EPG, press the  (EPG) button.

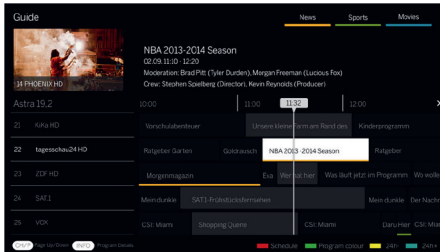

Note:

- EPG is only available for DVB stations.
- The first time you start EPG, a wizard will start that guides you through the necessary pre-settings.
- Depending on the number of stations selected for EPG, it may take some time until the programme information is displayed.

EPG Operation

In the left column there is a list of stations of the selected source/station list (e.g. DVB-C, personal list).

channel +/-: Scrolling in the station list page by page.

Up/Down arrows: Scrolling in the station list.

Left/Right arrows: Scrolling through the programmes.

In the station list the currently running programs are highlighted by lighter fields. A white vertical line indicates the current time in the running programs.

OK: Detailed information on the selected programme will be called.

Red Button: Opens schedule screen.

Green button: Displays a menu where you can assign colours to specific broadcast content (for example, News, Movies, Sport). Use the arrows and the OK button to assign the desired content type to a specific colour. Exit this menu by pressing the green button. Programmes that belong to the categories you selected are now highlighted in colour in the program guide.

Yellow button: View the previous day's list of programmes.

Blue button: View the next day's list of programmes.

Programme preview

Use arrows to mark desired station in the station list.

Press OK briefly to confirm selection.

In the top left window, the current programme of the selected station is displayed now.

Recording a programme via EPG

You can programme timer recordings of TV programmes conveniently using the EPG.

Press OK button to open Detailed info of selected programme.

Select option [Record] and press OK button.

Check the timer data and update it if necessary (e.g. directory, start, end, recording type).

In the EPG a recording symbol is placed behind the title of the programme.

Memorising a programme via the EPG

A programme that has not started yet can be memorised. For memorised programmes, the TV set will ask at the beginning of a programme if it should change the channel accordingly or switch on from the stand-by mode.

Mark the desired programme with arrows.

Press OK button to open Detailed info of selected programme.

Select option [Reminder] and press OK button.

In the EPG, a memorise symbol is placed behind the title of the programme.

Technical data

Changes of technical data and design of the equipment reserved.

| We. by Loewe device type: | | We. SEE 55 | We. SEE 50 | We. SEE 43 | We. SEE 32 |
|---|--|---|---|---|---|
| Part number: | | 60514x90 | 60513x90 | 60512x90 | 60510x80 |
| EU energy efficiency class: | | see enclosed energy label or under www.loewe.tv/int/support | | | |
| EPREL registration number: | | 620986 | 650532 | 695837 | 705091 |
| Screen diagonal: | | 139 cm/55 inch | 126 cm/50 inch | 108 cm/43 inch | 80 cm/32 inch |
| Power consumption On-Mode (max.) (Audio output 1/8 of the maximum value): | | 160 W | 135 W | 115 W | 70 W |
| Power consumption On-Mode (home): Energy consumption: | | see enclosed energy label or under www.loewe.tv/int/support | | | |
| Power consumption Standby Mode/ network standby mode: when set is switched off: | | 0,40 W/ 0,80 W ¹⁾ n.a. | 0,40 W/ 0,80 W ¹⁾ n.a. | 0,30 W/ 0,80 W ¹⁾ n.a. | 0,30 W/ 0,80 W ¹⁾ n.a. |
| Picture format / Resolution: | | Ultra HD 3840 x 2160 px / 16:9 | | | Full HD 1920 x 1080 / 16:9 |
| Display technology: | | LCD with E-LED backlight | | | |
| Device dimensions without stand (W ²⁾ x H x D): | | 124,4 x 74,1 x 7,6 cm | 112,0 x 67,6 x 7,6 cm | 97,6 x 58,9 x 6,6 cm | 73,6 x 45,6 x 7,6 cm |
| Device dimensions with stand (W ²⁾ x H x D): | | 124,4 x 75,1 x 25,4 cm | 112,0 x 68,9 x 26,3 cm | 97,6 x 60,2 x 20,2 cm | 73,6 x 46,7 x 20,2 cm |
| Weight without stand (approximate): | | 18,0 kg | 16,0 kg | 12,2 kg | 7,0 kg |
| Ambient temperature: | | 5° C – 35° C | | | |
| Relative humidity (non-condensing): | | 20 – 80% | | | |
| Air pressure: | | 800 – 1114 hPa (0 – 2000 m above sea level) | | | |
| Chassis designation: | | SL730 | | | SL710 |
| Power supply: | | 220 V – 240 V / 50 – 60 Hz | | | |
| Tuner: | terr./cable: Satellite: | VHF/Hyperband/UHF 4 levels: 13/18V/22kHz / 16 levels: DiSEqC 1.0 / single-cable system: EN 50494 | | | |
| Range: | terr./cable: Satellite: | 45 MHz up to 860 MHz 950 MHz up to 2150 MHz | | | |
| Channel storage locations incl. AV and radio: | | 10.000 | | | |
| TV standards: | analogue: digital: | B/G, D/K, I DVB-T/T2 HD, DVB-C HD, DVB-S/S2 HD (UHD on DVB at max. 60Hz) | | | |
| Colour standards: | | SECAM, PAL | | | |
| Sound formats: | analogue (FM): digital: | Mono, Stereo, 2-Ton PCM, MPEG, Dolby Audio, Dolby Atmos, Dolby MS12 | | | |
| Audio output power (sine / music): | | 2 x 20 W / 2 x 40 W | 2 x 20 W / 2 x 40 W | 2 x 15 W / 2 x 30 W | 2 x 15 W / 2 x 30 W |
| Acoustic speaker concept: | | Speaker box with bass reflex | | | |
| Teletext: | | HiText (Level 2.5) | | | |
| Page memory: | | 792 | | | |
| LAN: | Standards supported: | 10 Mbit/sec Ethernet (10Base-T)/100 Mbit/sec Fast Ethernet (100Base-T) | | | |
| WLAN: | Standards supported: | IEEE 802.11a/b/g/n, 802.11ac | | | |
| | Power/Frequency range: | Maximum power <100 mW at 2400-2483,5 MHz and 5150-5725 MHz | | | |
| | Supported encryption types: | WEP 64 and 128 Bit (ASCII and HEX), WPA PSK, WPA2 AES | | | |
| Bluetooth: | Power/Frequency range: Bluetooth protocols: | Bluetooth 5.0, Maximum power <10 mW bei 2,4 GHz A2DP SRC, A2DP SNK, HID | | | |
| Home networking standard: | | Universal Plug and Play Audio / Video (UPnP AV) | | | |
| Formats supported ¹⁾ : | Images: | JPEG, JPEG progressive (max. resolution 7680 x 4320), PNG, BMP, GIF, TIF | | | |
| | Audio: | MP3, M4A/AAC (AAC-LC, HE-AAC v1/v2), WMA (WMA, WMA Pro), FLAC, WAV (LPCM, ADPCM), Dolby Audio | | | |
| | Video: | MPG/MPEG (MPEG-2, 1920x1080p@120fps), MP4 (MPEG4 1920x1080p @ 120 fps, H.264 3840x2160p @ 30 fps, H.265 3840x2160p @ 60 fps, AV1 3840x2160p @ 60 fps), MOV (MPEG4 1920x1080p @ 120 fps, H.264 3840x2160p @ 30 fps, H.265 3840x2160p @ 60 fps), MKV (Mpeg2/4 1920x1080 @ 120 fps, H.264 3840x2160p @ 30 fps, H.265 3840x2160p @ 60 fps, AV1 3840x2160p @ 60 fps), FLV (H.264 3840x2160p @ 30 fps, H.265 3840x2160p @ 60 fps), WEBM (VP8 1920x1080p @ 120 fps, VP9 3840x2160p @ 60 fps, AV1 3840x2160p @ 60 fps) | | | |
| | | H.264/MPEG-4 AVC up to High Profile (Level 4.2) | | | |
| | | H.264/H.265 compatible with Dolby Vision/HDR10/HLG | | | |

¹⁾ (WoI/WoWLAN max.).

²⁾ The width of the TV set can be increased by up to 1 cm depending on the type of TV set in the area of the side-mounted Loewe brand label.

³⁾ For the playability of the individual formats no guarantee can be given.

Environment

Power consumption

Your TV set is equipped with an eco-standby power supply. In the standby mode, the power consumption drops to low power (see chapter **Technical data**). If you want to save even more energy then disconnect the device from the mains. Please also note that the EPG data (Electronic Programme Guide) is lost and possibly programmed timer recordings **cannot** be carried out by the TV set.

The TV set will be completely separated from mains only when you unplug the mains cable.

The power consumed by the TV set during operation depends on the setting in the system settings. To achieve the values specified in the technical data, it is necessary to deactivate the "Wake-on-LAN" function. If you activate this function, the annual energy consumption will not increase by more than 20%.

If you activate the automatic dimming, your TV picture will adapt to the ambient brightness. This reduces the power consumption of the TV set.

Automatic shutdown

If the TV is not operated for 4 hours (adjustment of volume, programme change, etc.) the TV will automatically switch to stand-by mode to save energy. A prompt to terminate this shutdown process appears one minute before the 4 hours expire.

Disposal

You have chosen a very high-value and durable product.

Packaging and cardboard

The disposal of the packaging will be gladly handled for you by your specialist dealer. If you dispose of the packaging yourself, dispose of the packaging in sorted waste disposal and according to the local disposal regulations. Place cardboard and paper in the waste paper, foils and polystyrene in the recyclable waste collection.

The set



Your We. by Loewe product is made with quality materials and components that are recyclable and reusable.

This symbol means that electrical and electronic equipment incl. cables must be disposed of separately from household waste at the end of their service life.

You can return your old set for free at designated recycling centres, or at your dealer, if you buy a similar new device.

Additional details about returns (even for non-EU countries) are also available from your local government. They make an important contribution to the protection of our environment.

The Batteries



The original equipment batteries do not contain harmful substances such as cadmium, lead or mercury.

Used batteries should not be disposed of in household waste. Dispose of used batteries free of charge in the collection containers set up at the dealer or at the public collection points.

Licenses



Dolby, Dolby Vision, Dolby Atmos, Dolby Audio, and the double-D symbol are registered trademarks of Dolby Laboratories Licensing Corporation. Manufactured under license from Dolby Laboratories.

Confidential unpublished works. Copyright © 2012-2020 Dolby Laboratories. All rights reserved.



For DTS patents, see <http://patents.dts.com>. Manufactured under license from DTS, Inc. (for companies headquartered in the U.S./Japan/Taiwan) or under license from DTS Licensing Limited (for all other companies). DTS, DTS-HD, and the DTS-HD logo are registered trademarks or trademarks of DTS, Inc. in the United States and other countries. © 2020 DTS, Inc. ALL RIGHTS RESERVED.



The Bluetooth® word mark and logos are registered trademarks of Bluetooth SIG Inc. and any use of such marks by Loewe Technology GmbH takes place under license. Other trademarks and trade names are those of their respective owners.

This set contains a software which is partly based on the work of the Independent JPEG Group.

This product includes software developed by the OpenSSL Project for use in the OpenSSL Toolkit (<http://www.openssl.org/>).

This software is provided by the OpenSSL project "as is" and any expressed or implied warranties, including, but not limited to, the implied warranties of merchantability and fitness for a particular purpose are disclaimed. In no event shall the OpenSSL project or its contributors be liable for any direct, indirect, incidental, special, exemplary, or consequential damages (including, but not limited to, procurement of substitute goods or services; loss of use, data, or profits; or business interruption) however caused and on any theory of liability, whether in contract, strict liability, or tort (including negligence or otherwise) arising in any way out of the use of this software, even if advised of the possibility of such damage.

This product includes cryptographic software written by Eric Young (ey@cryptsoft.com).

This product includes software written by Tim Hudson (tjh@cryptsoft.com).

This product contains software which was developed by third parties and / or software which is subject to GNU General Public License (GPL) and/or GNU Lesser General Public License (LGPL). You can pass on and modify them in accordance with Version 2 of the GNU General Public License or optionally every later version which is published by the Free Software Foundation.

The publication of this programme by Loewe is carried out WITHOUT ANY GUARANTEE OR SUPPORT, particularly without an implicit guarantee concerning MARKET MATURITY or the USABILITY FOR A SPECIFIC PURPOSE. Details can be found in the GNU General Public License. You can obtain the software via the Loewe customer service department.

The GNU General Public License can be downloaded from: <http://www.gnu.org/licenses/>.

Technical information

Notes on the LCD screen

The TV set with LCD screen you have purchased satisfies the most rigorous quality requirements and has been inspected with respect to pixel errors.

Despite of thorough care when manufacturing the display, it cannot be 100% guaranteed that no sub-pixel defects will occur due to technical reasons.

Please understand that these types of effects, as long as they are within the limits specified in the standard (ISO 9241-307, fault class II), cannot be considered as a device defect in terms of the guarantee.

Avoid displaying static images over a longer period. Image persistence errors may arise.

Information about connected USB hard drives

Never ever disconnect the USB storage device from the TV set during a copy process. Before switching off the set, we recommend you to switch it to standby mode.

Loewe are not liable for the loss of data on the integrated hard disk of your TV set. To avoid data loss, we recommend copying important recordings to an external storage medium.

Software-Update

Current software versions can be downloaded from the Loewe Internet site (see below) and installed on your TV set using a USB stick.

If your TV set is connected to the Internet, the TV set can be updated directly via the Internet.

For more information on the software update, please refer to the user handbook which can be downloaded from the Loewe Internet site.

Compatibility

It cannot be guaranteed that We. by Loewe models

will work initially and permanently with all connectable peripherals.

Possible setup solutions

You can use the following Loewe setup solutions listed for your TV set.

Do not use any setup solutions that are not approved for your TV set.

Loewe floor2ceiling stand

Loewe floor stand flex

Loewe floor stand universal

Loewe floor stand c

Loewe wall mount slim 432

Loewe wall mount slim 221

Loewe wall mount universal

Conformity / Manufacturer's declaration

Hereby, Loewe Technology GmbH declares that this product meets the essential requirements and other relevant provisions of Directive 2014/53/EU and all applicable EU directives.

In the frequency range 5150 to 5350 MHz, this TV set is restricted to indoor use in the following countries: Belgium, Bulgaria, Denmark, Germany, Estonia, Finland, France, Greece, Ireland, Italy, Croatia, Latvia, Lithuania, Luxembourg, Malta, Netherlands, Austria, Poland, Portugal, Romania, Sweden, Slovakia, Slovenia, Spain, Czech Republic, Hungary, United Kingdom, Cyprus.

You can find the complete declaration of conformity in the product selection at:

www.loewe.tv/int/support

Imprint

Loewe Technology GmbH



Industriestraße 11
D-96317 Kronach
www.loewe.tv

Printed in Germany

Editorial date 02/21-1.0 MJ/JK/SB

© Loewe Technology GmbH, Kronach

The information in this document is subject to change without notice and does not constitute any obligation on the part of Loewe Technology GmbH.

All rights including translation, technical modifications and errors reserved.

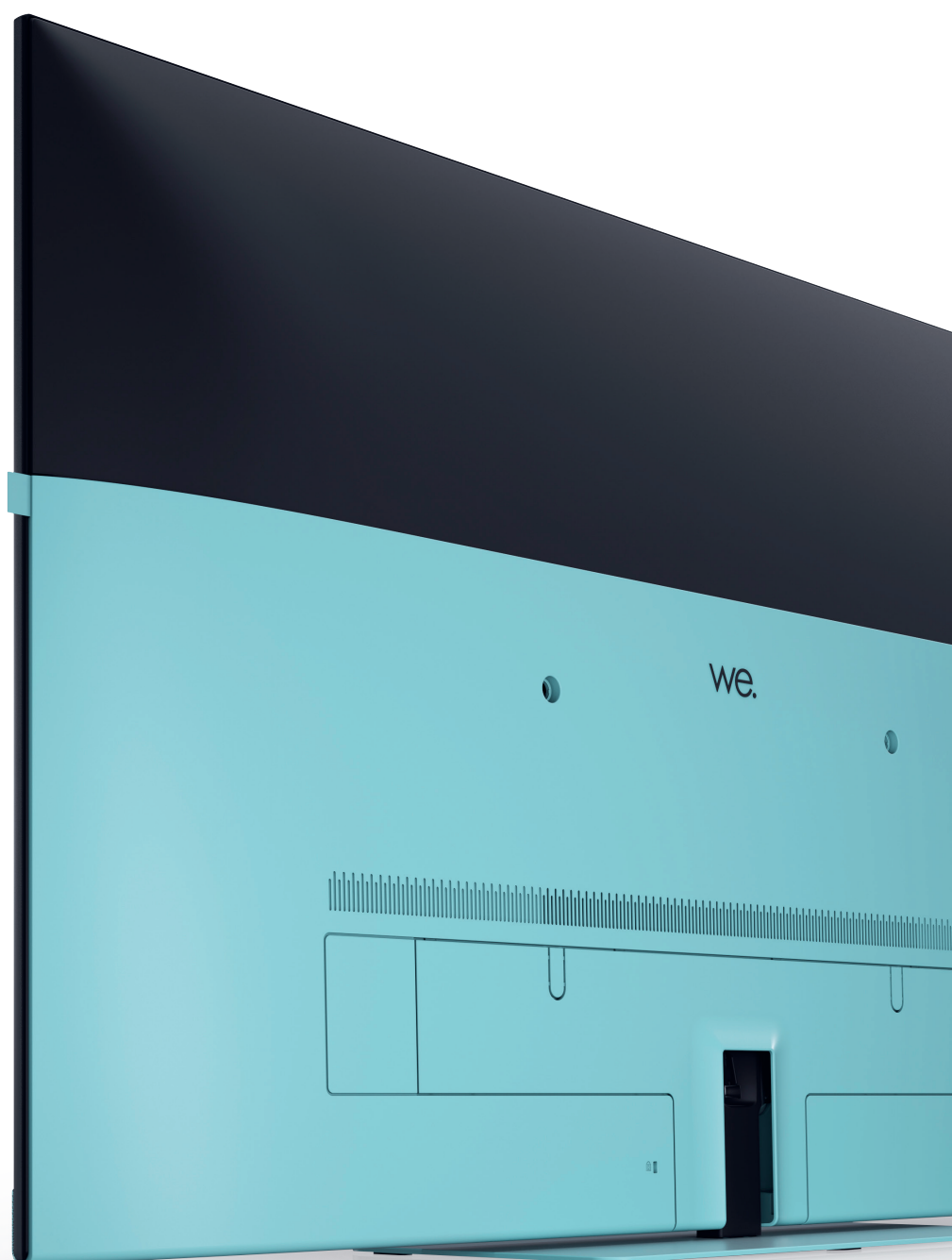

Loewe Technology GmbH

Customer Care Center
Industriestraße 11
96317 Kronach, Deutschland
Tel +49 9261 99-500
Fax +49 9261 99-515
E-mail: we@loewe.de
Printed in Germany
Edition 2, 08.21 MJ/JK/LC

Subject to modifications