

SENCOR®

SMS 2100WH



ELECTRIC SHAVER
Translation of the original manual



SENCOR®

SMS 2100WH



A

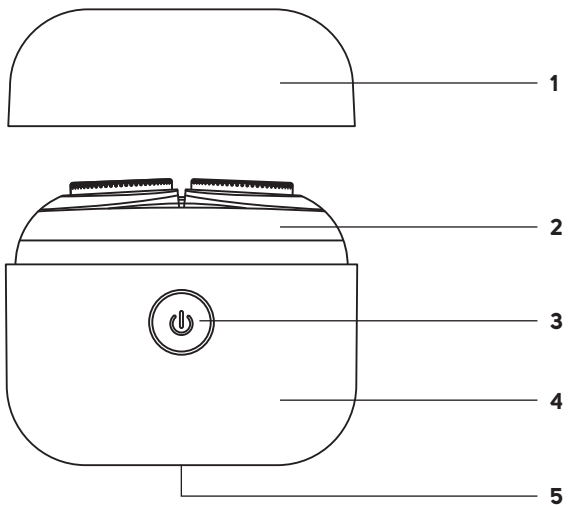

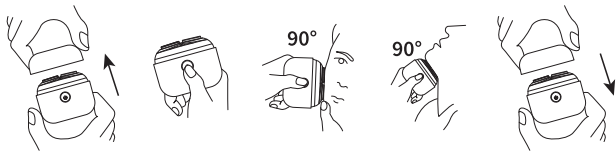
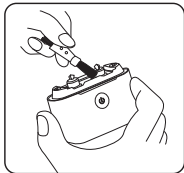
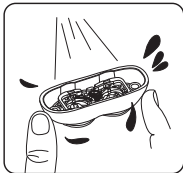
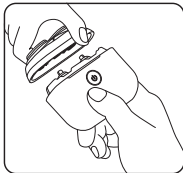
B**C**

IMPORTANT SAFETY INSTRUCTIONS

READ CAREFULLY AND STORE FOR FUTURE USE.

- This appliance may be only used by children aged 8 years and older and by persons with physical, sensory or mental impairments or lack of experience and knowledge, if they are supervised or have been instructed on the safe use of the appliance and understand the potential hazards.
- Children must not play with the appliance.
- Cleaning and maintenance must not be performed by unsupervised children.
- If the charging cable is damaged, have it replaced in a professional service centre in order to prevent a dangerous situation. It is forbidden to use the appliance with the charging cable damaged.



WARNING: Keep the appliance dry.

Do not use the appliance in the bath or shower. Do not clean the appliance under the tap, spray it with water or other liquid, or immerse it in water or other liquid.

-
- Before connecting the appliance to a power socket, check that the nameplate rated voltage matches the voltage of the power socket.

- Use the appliance only with the supplied charging cable. To avoid a dangerous situation, do not use other types of charging cable.
- Keep the charging cable dry.
- Do not place the power cord over sharp objects. Make sure that it does not hang over the edge of a table or touch a hot surface.
- Do not wind the charging cable around the handle of the appliance.
- Do not connect or disconnect the charging cable with wet or damp hands.
- Store, charge and use the appliance at an ambient temperature of 15°C to 35°C. Do not charge the appliance for longer than necessary to fully charge it. After charging, disconnect it from the power source.
- Do not expose the appliance to temperatures above 50°C. Otherwise damage to the built-in battery may occur.
- The appliance is equipped with a built-in battery with a long service life, which can only be removed by a professional service. Never attempt to remove it from the appliance by yourself.



Caution:

Never disassemble the appliance in order to remove the battery. Do not short-circuit the appliance or throw it into a fire. There is a risk of leakage of toxic substances, fire or explosion if improperly handled.

- Do not charge, use, store or leave the appliance in a bathroom or any other place where it could fall into a bathtub, wash basin or any other container filled with water.
- If the appliance falls into water, under no circumstances should you touch it, but immediately disconnect the power adapter from the socket. Never use an appliance or power adapter that has been submerged in water. Take it to an authorised service centre for inspection.
- This shaver is designed for domestic use only and is used for shaving and trimming beards or facial hair. The shaver is not intended for commercial purposes or for trimming animal fur.
- Use the shaver only on dry and clean beard or facial hair. Do not use it on wet beards or beards with shaving foam, gel, etc. on them.
- We do not recommend using the shaver on parts of the face with open or cut wounds, burns, blisters, etc.

- For hygiene reasons, the shaver head should only be used by one person.
 - Use the shaver in accordance with the instructions in this manual.
 - Use only the original accessories supplied with this shaver.
 - The shaver and its power adapter must only be used indoors. Do not use them outdoors.
 - Avoid using the shaver in rooms where aerosol dispensers are used or where oxygen is administered.
 - Do not expose the shaver to the outdoor environment, extreme temperatures, direct sunlight, excessive humidity or excessive dust.
 - Do not place the shaver near heaters, open fires or other sources of heat.
 - Before using it, always check that the shaving head is not damaged. Never use a shaver with a damaged shaving head.
 - The shaver may heat up when used or recharged. This is completely normal.
 - Keep the shaver at a safe distance from your eyes.
 - Always turn off the shaver and disconnect it from the power socket if you will not be using it, will be leaving it unsupervised, before cleaning, maintenance or storing it. Store the shaver and its power adapter in a dry environment.
 - Keep the shaver clean. Perform the cleaning and maintenance following the instructions in the Cleaning and Maintenance section.
 - Do not perform any maintenance on the shaver other than cleaning its individual components as described in the Cleaning and Maintenance section.
 - Never use a shaver or power adapter that is damaged in any way.
 - Do not use the shaver if it has fallen on the floor, if it was submerged in water, if it is not functioning properly or if it is damaged in any other way.
 - To avoid a hazardous situation arising, do not repair or modify the shaver or its accessories yourself. Contact an authorised service centre for all repairs. By interfering with the product, you risk losing the legal right to defective performance or warranty for quality.
-

EXPLANATION OF SYMBOLS PLACED ON THE PRODUCT OR IN THE ACCOMPANYING DOCUMENTATION



The product meets all the basic requirements of the applicable EU directives.



This symbol on products or original documents means that used electric or electronic products must not be added to ordinary municipal waste.



This symbol on the accumulator or battery means that the used battery must not be added to normal municipal waste.

EN Electric Shaver

User Manual

- Thank you for purchasing our SENCOR product; we hope it will serve to your satisfaction.
 - Prior to using this appliance, please read the user manual thoroughly, even in cases when you are already familiar with the use of similar types of appliances. Use the appliance only as described in this user manual. Keep the manual for future reference. If you pass the appliance on to another person, ensure that this user manual is included.
 - Carefully unpack the appliance and make sure not to discard any part of the packaging material until you have removed all its components. It is recommended that you keep the original packaging, packing material, receipt and confirmation of the extent of the seller's liability or warranty certificate at least for the duration of the legal right to file a defect claim or the quality warranty. When transporting the appliance, we recommend repackaging it in the original box provided by the manufacturer.
-

DESCRIPTION OF THE ELECTRIC RAZOR

A1 Protective blade cap

A2 Shaving head

A3  On/Off button

A4 Shaver body



A5 Charging socket

.....

INTENDED USE

- The electric shaver is designed for dry shaving beards and trimming sideburns, moustaches or smaller hairs. The electric shaver is not intended for wet shaving or cutting artificial hair or animal hair.
-

CHARGING

- The electric shaver is equipped with a built-in battery that allows it to be used without the power cord.
- Allow the shaver battery to fully charge first without turning it on before first use or after a long period of non-use.
- Insert the USB-A connector of the charging cable into the socket in the power adapter (not included) and insert the adapter plug into a properly grounded power socket.
- Insert the USB-C connector into the socket on the underside of the electric shaver. The shaver will start charging. The  button will flash as it charges. When it goes out, the shaver is fully charged.
- Disconnect the charging cable from the shaver and remove the power adapter from the socket.
- The charging time is approximately 1 hour. Nevertheless, the charging time varies depending on the current charge level of the battery. If the battery is completely flat, it may take up to 1.5 hours to charge.
- When fully charged, the electric shaver will work for approximately 60 minutes. It will then need to be recharged.
- The  button will flash white when the charge level is low. Allow the electric shaver to charge.



Caution:

Do not leave the electric shaver connected to the mains for longer than it takes to fully charge it.

.....

RECOMMENDATIONS FOR EXTENDING BATTERY LIFE

- To keep the built-in battery working for as long as possible, charge, use and store the electric shaver at an ambient temperature of 15–35°C in a dry environment. Lower or higher temperatures adversely affect the life of the battery.
- Do not wait until the battery is completely discharged. It is better to recharge the battery before it is fully discharged.

- If you do not use the electric shaver for a long time, charge the battery at least once every 6 months.
-

USING THE SHAVER (Fig. B)

- Remove the protective blade cap.
- Turn on the shaver by pressing the  button.
- Hold the electric shaver at a right angle to the surface of the skin and in short circular movements sweep the shaving head over the skin of the face in the opposite direction to the growth of the beard. Apply adequate pressure to the skin. Do not push too hard.
- In more difficult to reach places, such as on the chin, stretch the skin with your free hand. This will give you a better shaving result.



Note:

Your skin and beard may take up to three weeks to get used to the new way of shaving. During this time it is recommended to use the electric shaver daily.

- Press the  button to turn off the shaver.
 - When you have finished shaving, clean the electric shaver according to the instructions in the Cleaning and Maintenance section.
 - Replace the protective blade cap if you will not be using the shaver, are leaving it unattended, or storing it.
-

CLEANING AND MAINTENANCE

- For hygiene reasons, clean the electric shaver after each use. Regular cleaning is also important to keep the electric shaver working properly and extends the life of the shaving cutters.
- Turn the electric shaver off before cleaning it. Never clean the electric shaver when it is plugged into the power supply to recharge.
- Do not use hard-bristled brushes, abrasive cleaners, thinners, etc. Otherwise the surface to be cleaned may be damaged.

**Caution:**

To avoid the risk of electric shock, do not immerse the shaver or charging cable in water or any other liquid.

Cleaning the shaver (Fig. C)

- Remove the protective blade cap.
 - Remove the shaving head from the shaver body. You can rinse the shaving head under a weak stream of running water. Tap and wipe dry or allow to dry properly.
 - Use a soft brush to remove any beard and hair residue from the shaver body.
 - Wipe the body of the shaver using a dry cloth.
 - Put the dry shaver head back on the body of the shaver and put on the protective blade cap.
-

STORAGE

- Store the clean shaver in a well-ventilated place out of reach of children and pets. Check that the protective blade cap is correctly fitted to prevent unwanted damage to the shaver head during storage.
 - Do not place any objects on the shaver.
-

TECHNICAL SPECIFICATIONS

Input voltage	5 V/1 A
Power consumption	8W
Battery	Li-Ion, 3,7 V, 500 mAh
Charging time	1 hour
Operating time	60 minutes
Dimensions	70.3 × 64.3 × 28.8 mm
Weight	112.6 g
Noise level	<70 dB (distance: 20 cm)
Protection class	IPX4

Values provided according to Commission Regulation EU 2023/826

Off mode	
Power consumption in off mode	0 W
Time needed for the equipment to automatically reach off mode	0 min
Standby Mode	
Power consumption in standby mode	-
Time needed for the equipment to automatically reach standby mode	-
Networked standby mode (Wi-Fi)	
Power consumption in networked standby	-
Time needed for the equipment to automatically reach networked standby mode	-

.....

BATTERY DISPOSAL

Before disposing of the product or returning it to a designated collection point, ensure that the battery is removed. The battery contains environmentally harmful substances. Proper disposal shall be ensured by the relevant collection point.

.....

INSTRUCTIONS AND INFORMATION ON DISPOSAL OF USED PACKAGING MATERIAL

Dispose of used packaging material at the designated municipal waste disposal site.

.....

DISPOSAL OF USED ELECTRICAL AND ELECTRONIC EQUIPMENT

Used electrical and electronic products must not be disposed of in ordinary municipal waste. To enable the proper disposal, renewal and recycling of these products, deliver them to the designated collection points. Alternatively, in some European Union states or other European countries the products can be returned to the local retailer when buying an equivalent new product. By properly disposing this product, you help preserve valuable natural resources and help to prevent potential damage to the environment and human health resulting from improper waste disposal. For more details, contact your local authority or nearest collection point. Fines may be imposed for the improper disposal of this type of waste as per national regulations.

For business entities in European Union States

If you wish to dispose of electrical and electronic equipment, please request the necessary information from your retailer or supplier.

Disposal in other countries outside the European Union

To dispose of this product elsewhere, request the necessary information on the correct disposal method from local authorities or your retailer.

.....

Changes to text and technical parameters are reserved.

FAST ČR, a.s.
U Sanitasu 1621
CZ-251 01 Říčany
www.sencor.com
info@sencor.cz